

Zusätzliche Räumlichkeiten der Fakultät im Softwarepark:

- | | |
|---|--|
| 1 Studentenheim 3 (SH3), Ebene 0
ÖH Students' Corner | 8 Meierhof
Research Center Labs, Büros |
| 2 Studentenheim 4 (SH4), Ebene 0 | 9 Meierhof
Coworking Space |
| 3 ARCHIV, HSD Seminarraum SH02 | 10 Studentenheim 1 (SH1)
Lager |
| 4 Studentenheim 6 (SH6), Ebene 0 und 1 | 11 Studentenheim 2 (SH2)
Betriebsrat |
| 5 Projektraum OP | |
| 6 PIE-Lab | |
| 7 Studentenheim 2 (SH2) + 3 (SH3)
Research Center Labs, Büros | |

Gastronomie (Menüs: www.heute-mittag.at):

- | | | |
|------------------------|--------------------------------------|----------------------------|
| A Mensa Campina | F Restaurant Salz und Pfeffer | J Pizzeria Lavinya |
| B Pub Loungerie | G Bäckerei/Cafe Honeder | K Gasthaus Hametner |
| C nSquare | H Restaurant Park | L Café Monika |
| E Burgerei | I Schlossrestaurant | M Gxunderia |

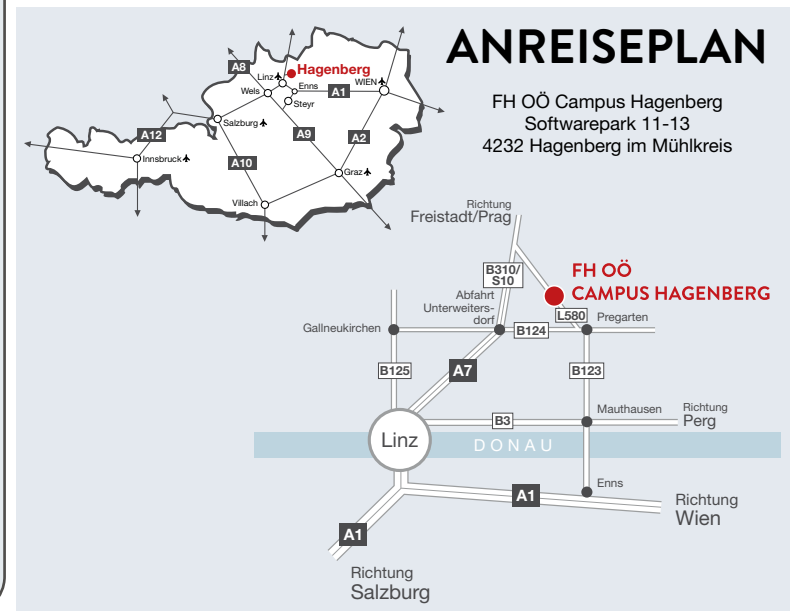

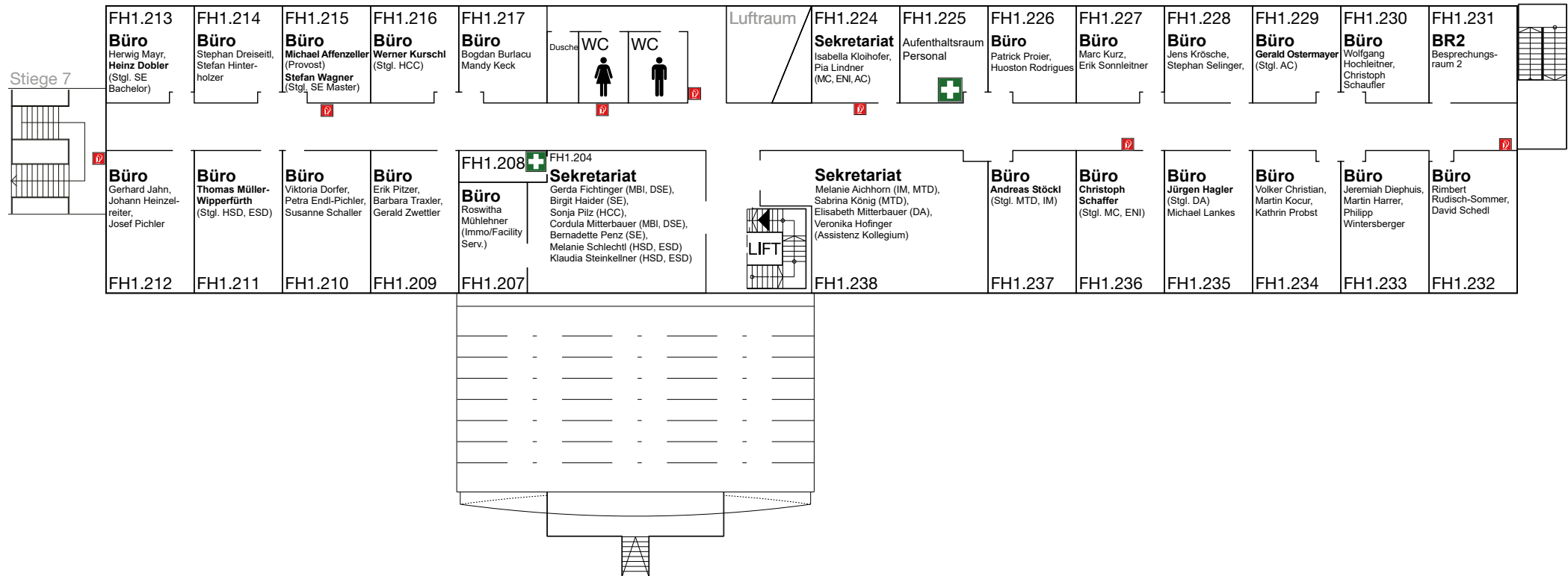

FH-Gebäude 1 Ebene 2

MBI/DSE	SE/HCC/IEM	SIB/SIM/ISM	HSD/ESD	AC/DDP/MC/ENI	KWM	MTD/DA/IM
Medizin- und Bioinformatik, Data Science und Engineering	Software Engineering, Human-Centered Computing, Information Engineering und -Management	Sichere Informationssysteme (Bachelor/Master), Information Security Management	Hardware-Software-Design, Embedded Systems Design	Automotive Computing, Design of Digital Products, Mobile Computing (Ba/Ma), Energy Informatics	Kommunikation, Wissen, Medien (Bachelor/Master)	Medientechnik und -design, Digital Arts (Bachelor/Master), Interactive Media

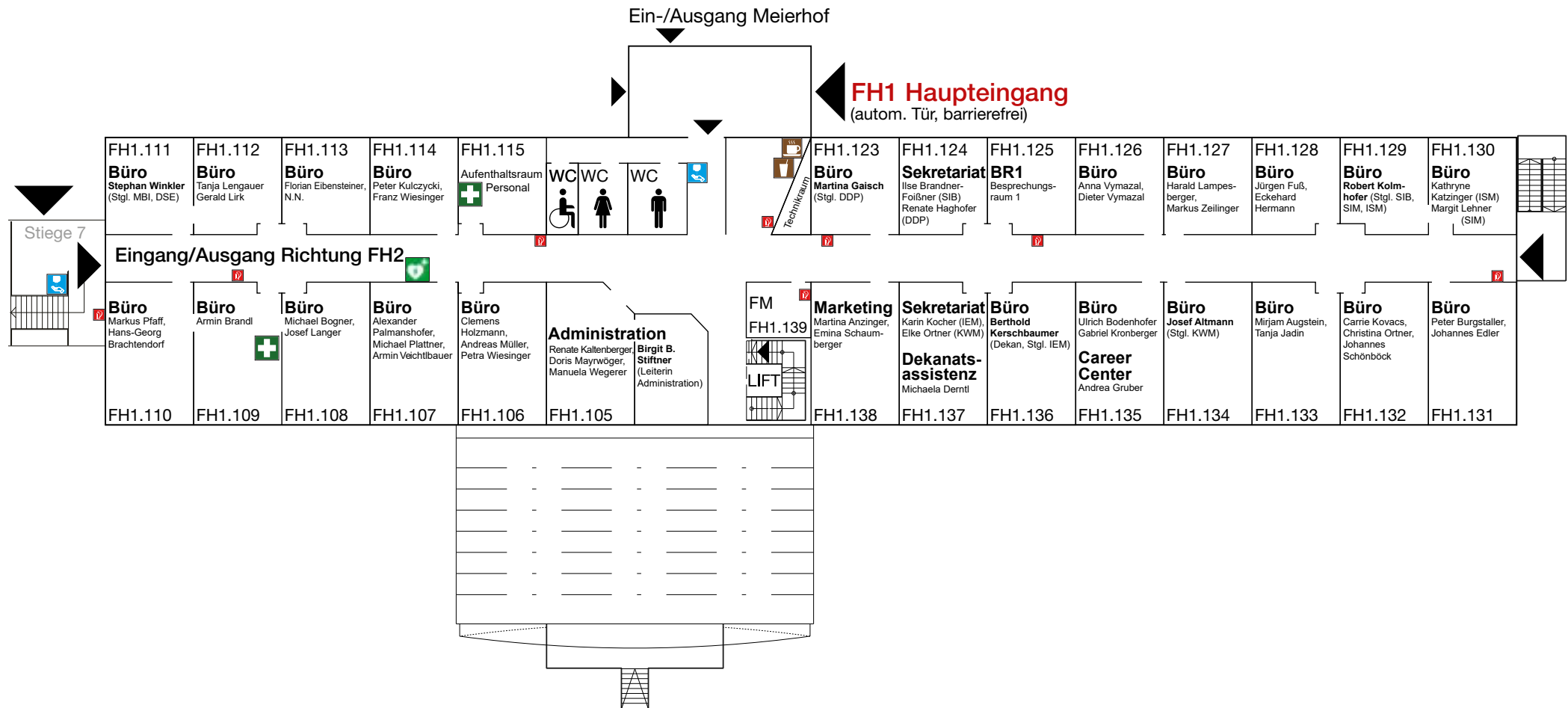

FH-Gebäude 1 Ebene 1

MBI/DSE	SE/HCC/IEM	SIB/SIM/ISM	HSD/ESD	AC/DDP/MC/ENI	KWM	MTD/DA/IM
Medizin- und Bioinformatik, Data Science und Engineering	Software Engineering, Human-Centered Computing, Information Engineering und -Management	Sichere Informationssysteme (Bachelor/Master), Information Security Management	Hardware-Software-Design, Embedded Systems Design	Automotive Computing, Design of Digital Products, Mobile Computing (Ba/Ma), Energy Informatics	Kommunikation, Wissen, Medien (Bachelor/Master)	Medientechnik und -design, Digital Arts (Bachelor/Master), Interactive Media

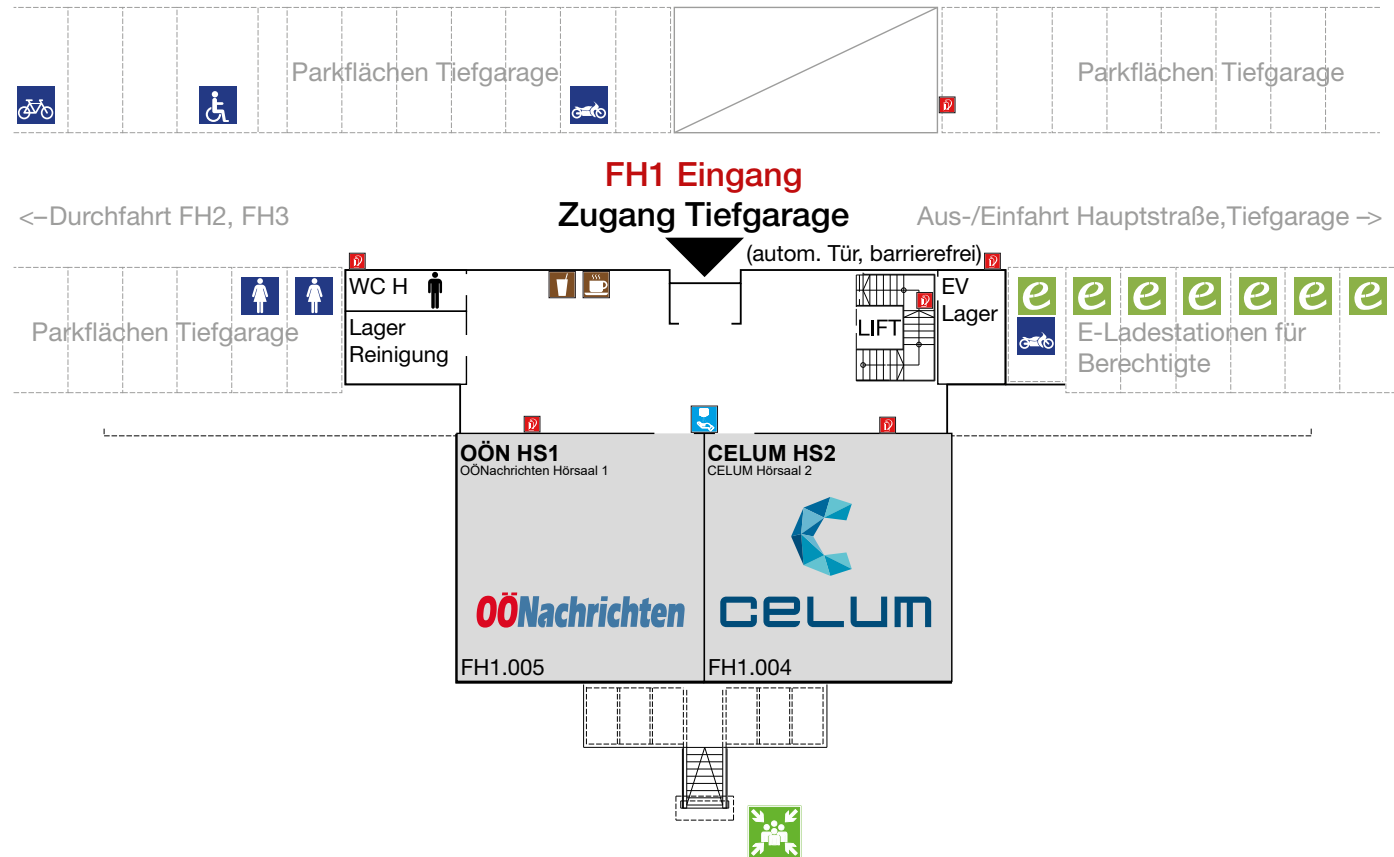

FH-Gebäude 1 Ebene 0

MBI/DSE	SE/HCC/IEM	SIB/SIM/ISM	HSD/ESD	AC/DDP/MC/ENI	KWM	MTD/DA/IM
Medizin- und Bioinformatik, Data Science und Engineering	Software Engineering, Human-Centered Computing, Information Engineering und -Management	Sichere Informationssysteme (Bachelor/Master), Information Security Management	Hardware-Software-Design, Embedded Systems Design	Automotive Computing, Design of Digital Products, Mobile Computing (Ba/Ma), Energy Informatics	Kommunikation, Wissen, Medien (Bachelor/Master)	Medientechnik und -design, Digital Arts (Bachelor/Master), Interactive Media

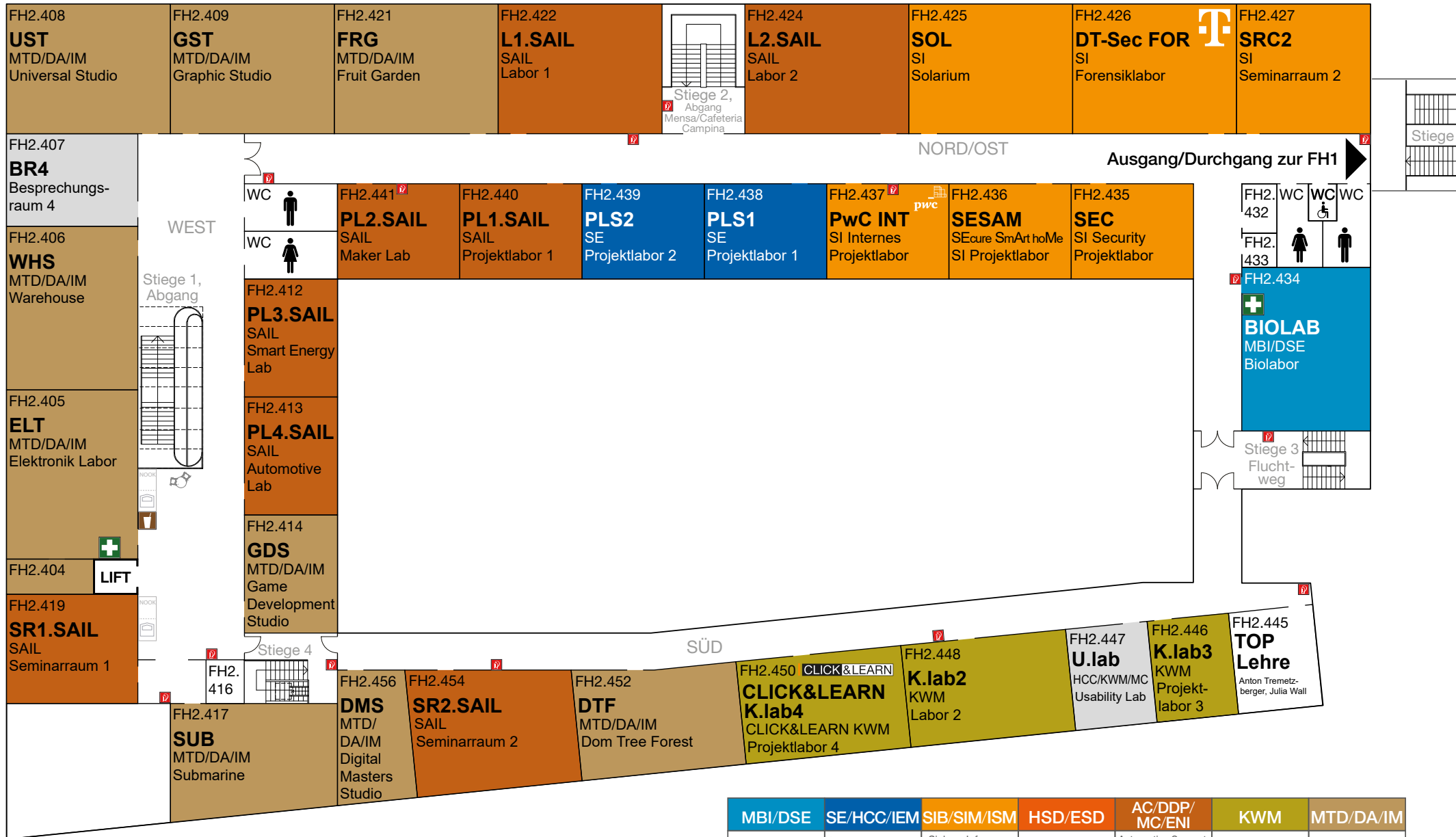

FH-Gebäude 2 Ebene 4

MBI/DSE	SE/HCC/IEM	SIB/SIM/ISM	HSD/ESD	AC/DDP/MC/ENI	KWM	MTD/DA/IM
Medizin- und Bioinformatik, Data Science und Engineering	Software Engineering, Human-Centered Computing, Information Engineering und -Management	Sichere Informationssysteme (Bachelor/Master), Information Security Management	Hardware-Software-Design, Embedded Systems Design	Automotive Computing, Design of Digital Products, Mobile Computing (Ba/Ma), Energy Informatics	Kommunikation, Wissen, Medien (Bachelor/Master)	Medientechnik und -design, Digital Arts (Bachelor/Master), Interactive Media

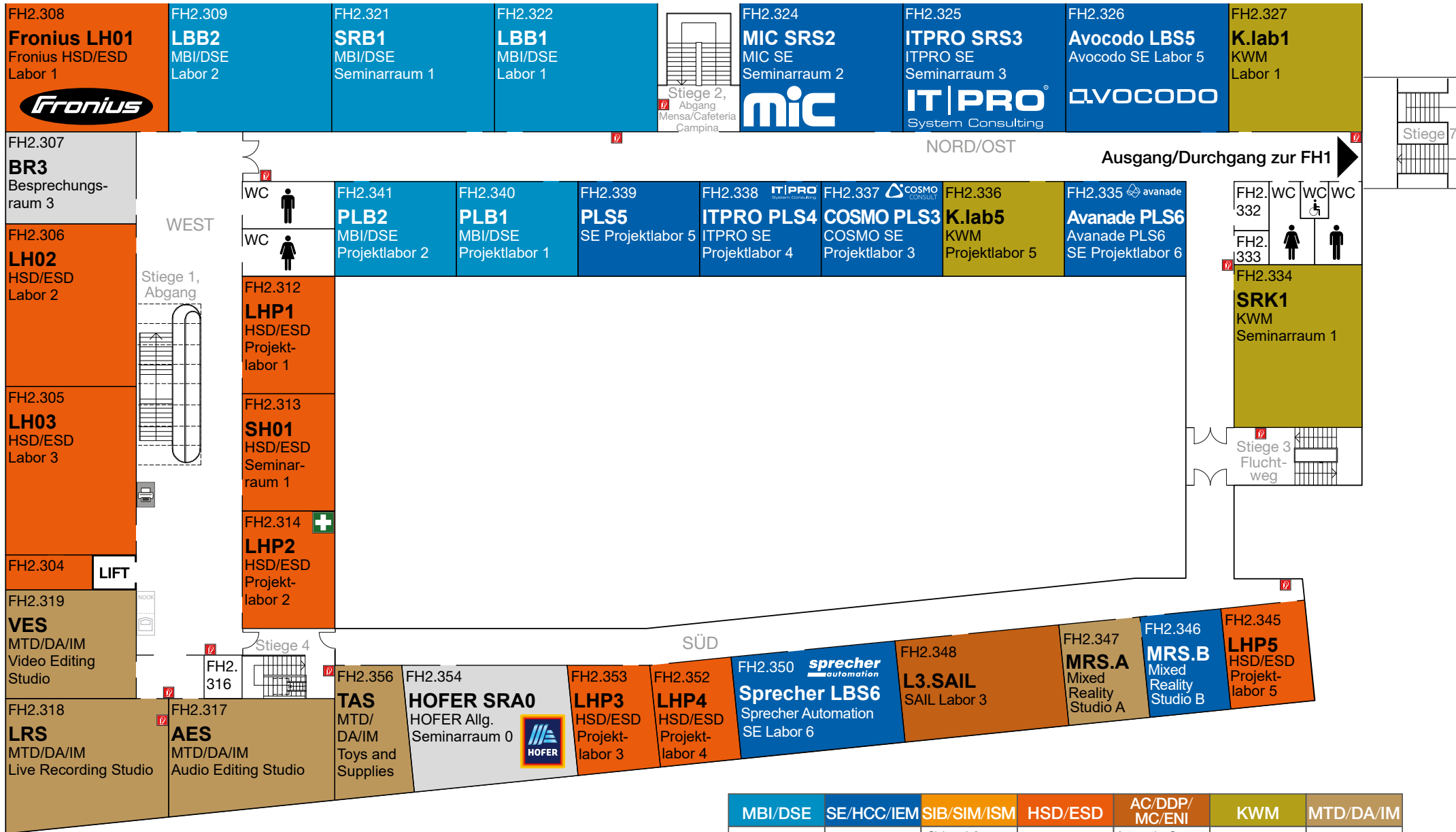

FH-Gebäude 2 Ebene 3

MBI/DSE	SE/HCC/IEM	SIB/SIM/ISM	HSD/ESD	AC/DDP/MC/ENI	KWM	MTD/DA/IM
Medizin- und Bioinformatik, Data Science und Engineering	Software Engineering, Human-Centered Computing, Information Engineering und -Management	Sichere Informationssysteme (Bachelor/Master), Information Security Management	Hardware-Software-Design, Embedded Systems Design	Automotive Computing, Design of Digital Products, Mobile Computing (Ba/Ma), Energy Informatics	Kommunikation, Wissen, Medien (Bachelor/Master)	Medientechnik und -design, Digital Arts (Bachelor/Master), Interactive Media

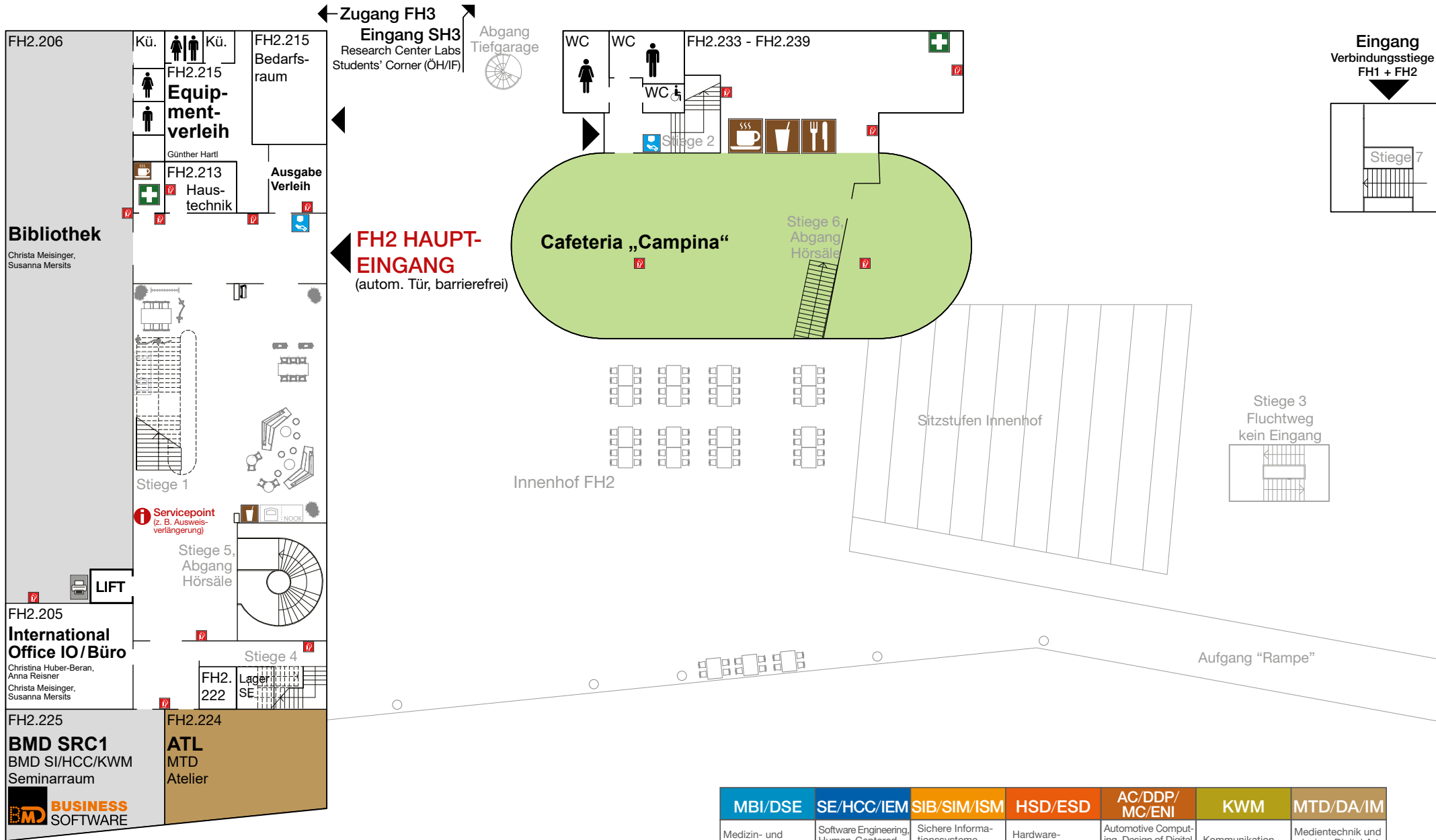

FH-Gebäude 2 Ebene 2

MBI/DSE	SE/HCC/IEM	SIB/SIM/ISM	HSD/ESD	AC/DDP/MC/ENI	KWM	MTD/DA/IM
Medizin- und Bioinformatik, Data Science und Engineering	Software Engineering, Human-Centered Computing, Information Engineering und -Management	Sichere Informationssysteme (Bachelor/Master), Information Security Management	Hardware-Software-Design, Embedded Systems Design	Automotive Computing, Design of Digital Products, Mobile Computing (Ba/Ma), Energy Informatics	Kommunikation, Wissen, Medien (Bachelor/Master)	Medientechnik und -design, Digital Arts (Bachelor/Master), Interactive Media

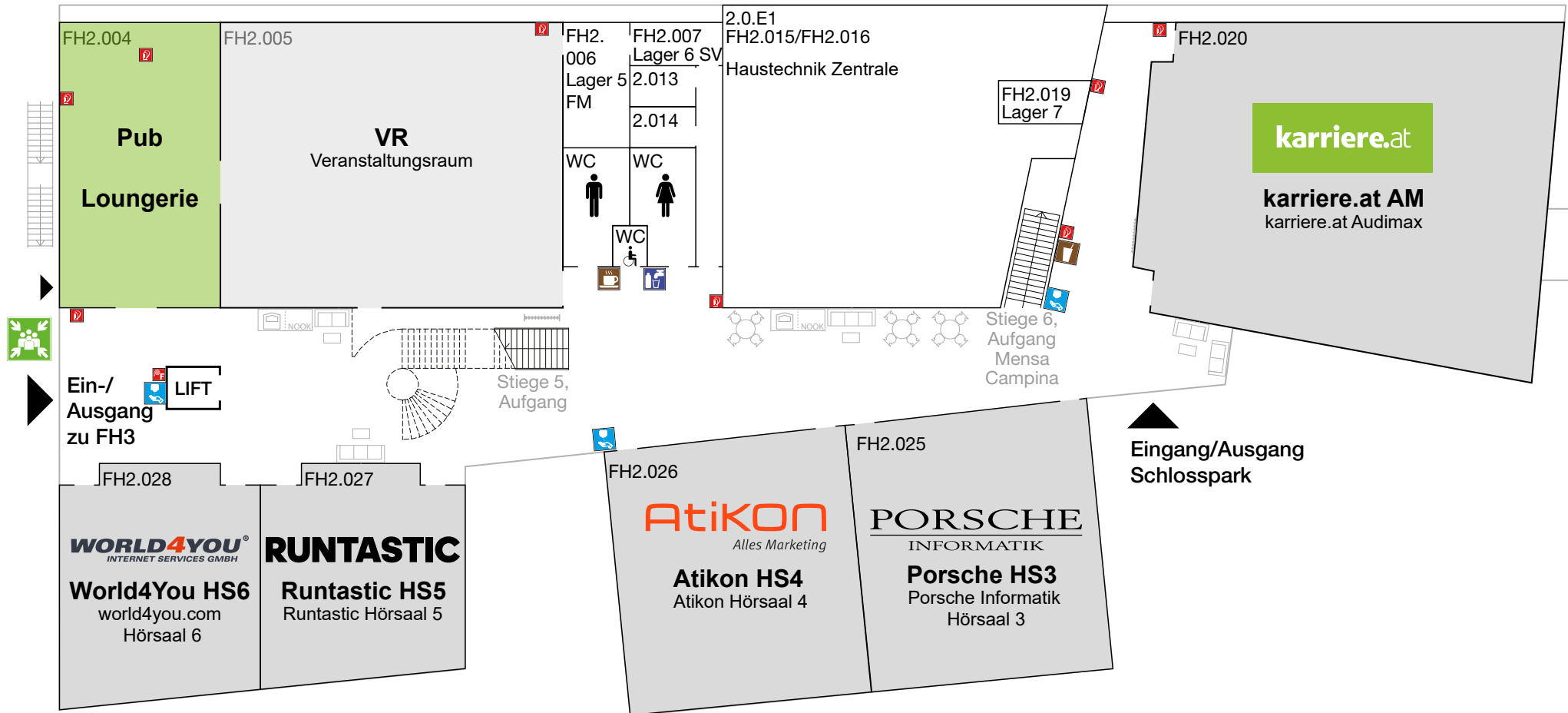

FH-Gebäude 2 Ebene 0

MBI/DSE	SE/HCC/IEM	SIB/SIM/ISM	HSD/ESD	AC/DDP/MC/ENI	KWM	MTD/DA/IM
Medizin- und Bioinformatik, Data Science und Engineering	Software Engineering, Human-Centered Computing, Information Engineering und -Management	Sichere Informationssysteme (Bachelor/Master), Information Security Management	Hardware-Software-Design, Embedded Systems Design	Automotive Computing, Design of Digital Products, Mobile Computing (Ba/Ma), Energy Informatics	Kommunikation, Wissen, Medien (Bachelor/Master)	Medientechnik und -design, Digital Arts (Bachelor/Master), Interactive Media

FH3 EBENE 5

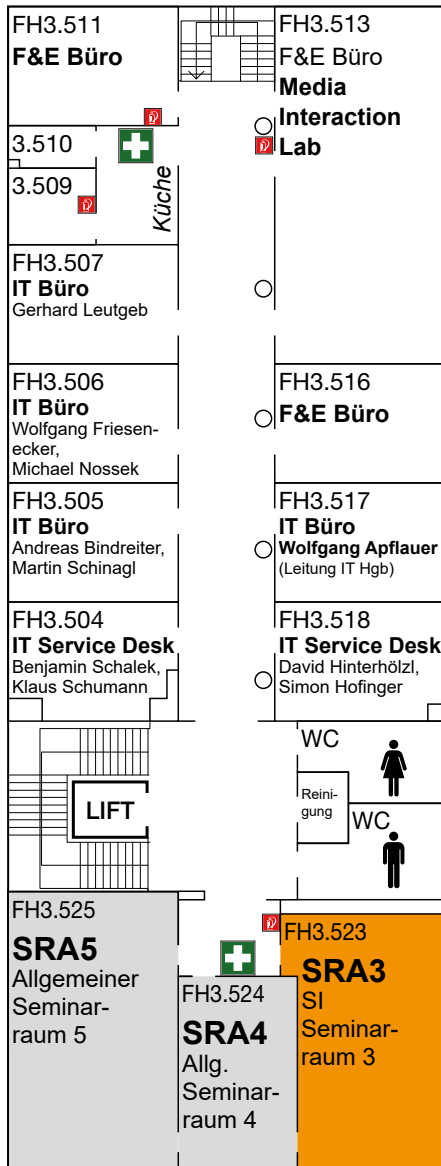

FH-Gebäude 3 Ebene 5

FH3 EBENE 4

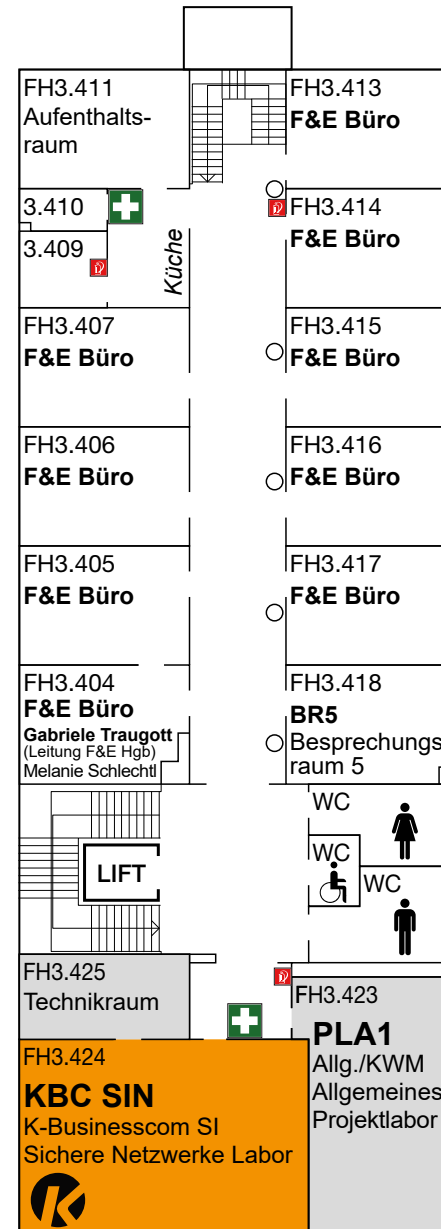

FH-Gebäude 3 Ebene 4

FH3 EBENE 3

FH3 HAUPT-EINGANG

(autom. Tür, barrierefrei)

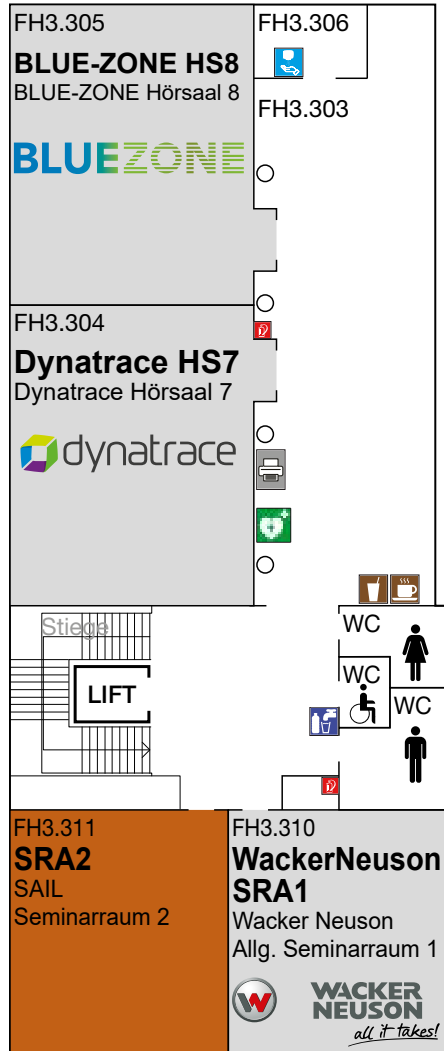

FH-Gebäude 3 Ebene 3

FH3 EBENE 2

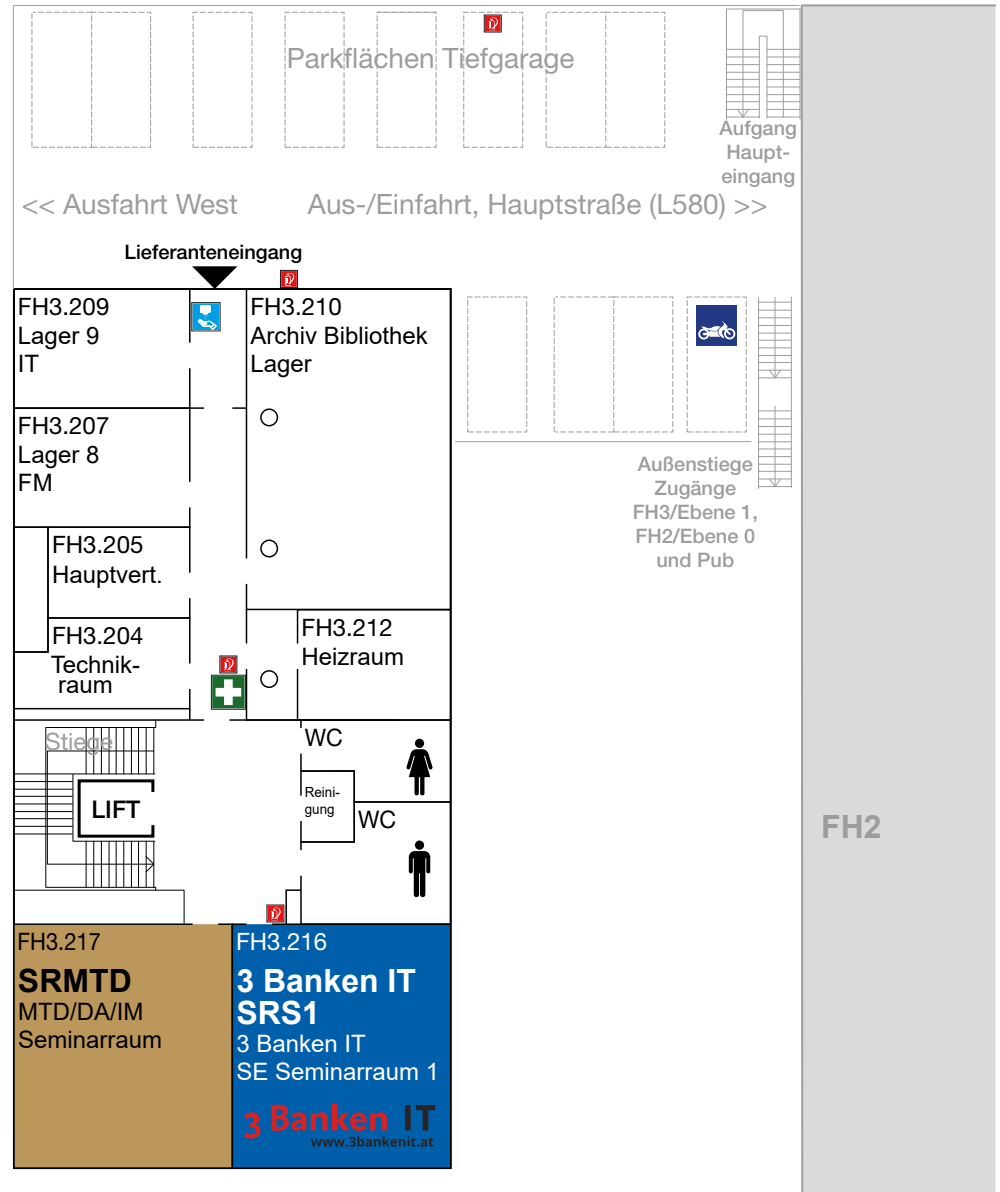

FH-Gebäude 3 Ebene 2

FH3 EBENE 1

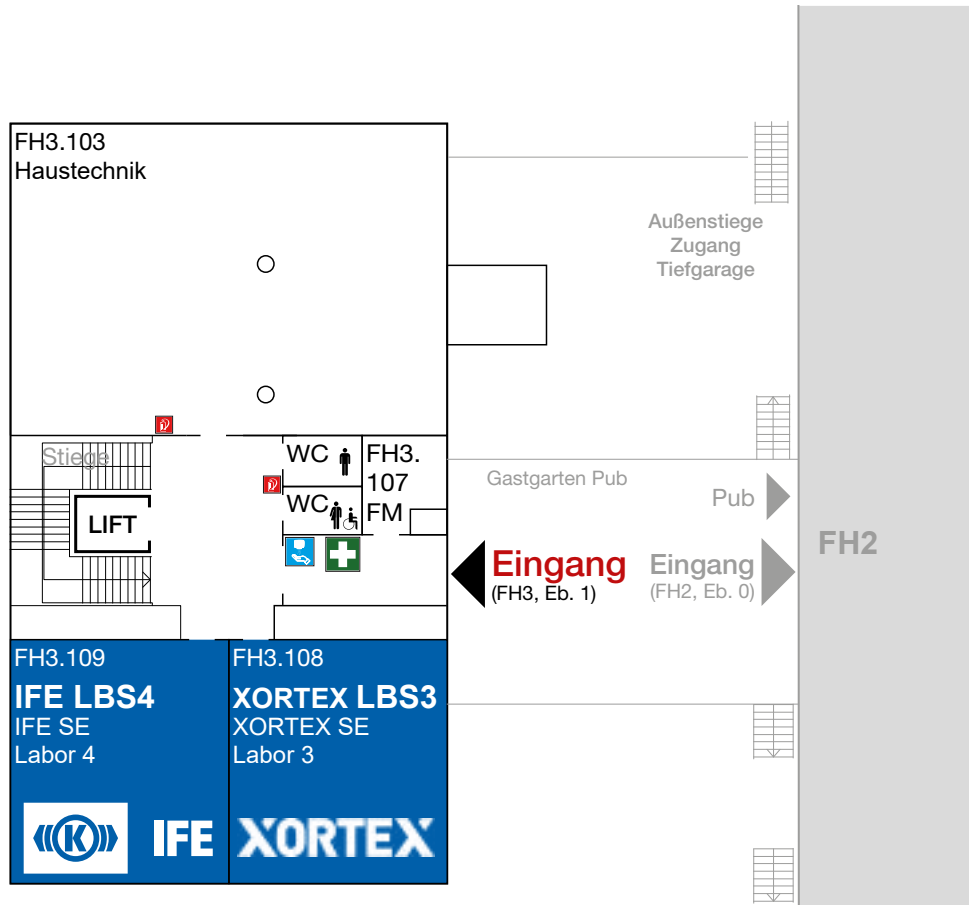

FH-Gebäude 3 Ebene 1

FH3 EBENE 0

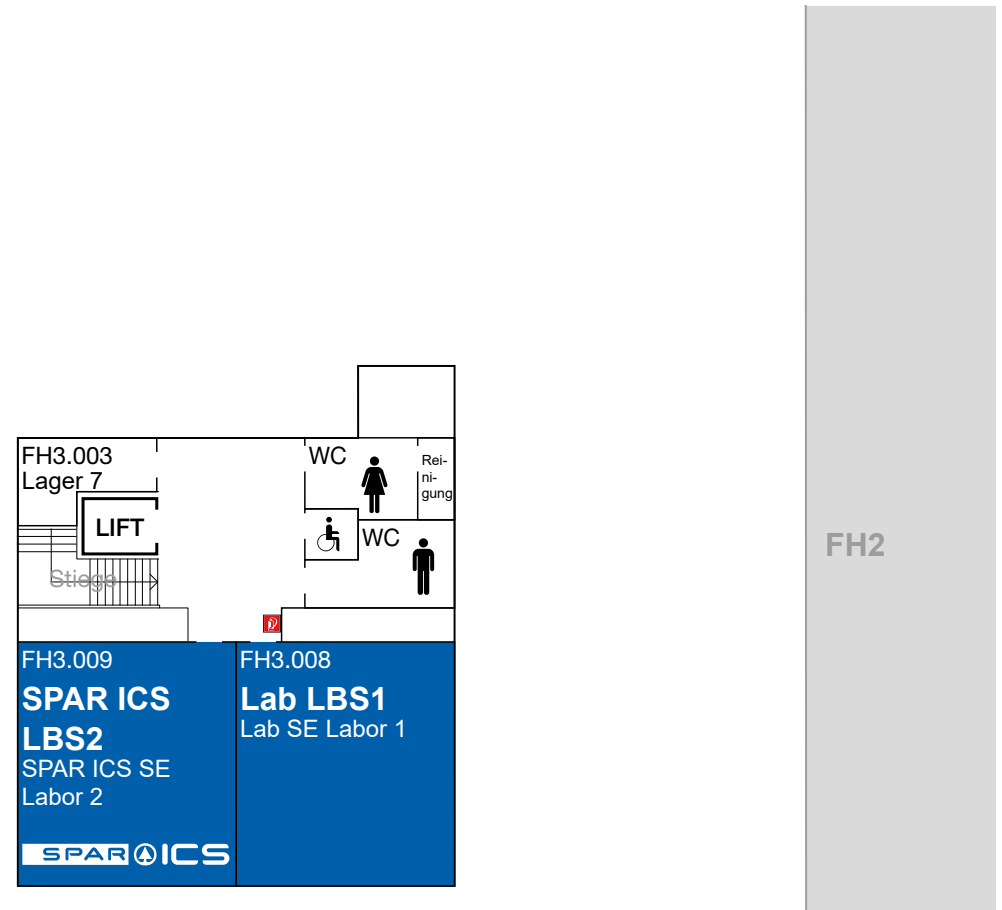

FH-Gebäude 3 Ebene 0

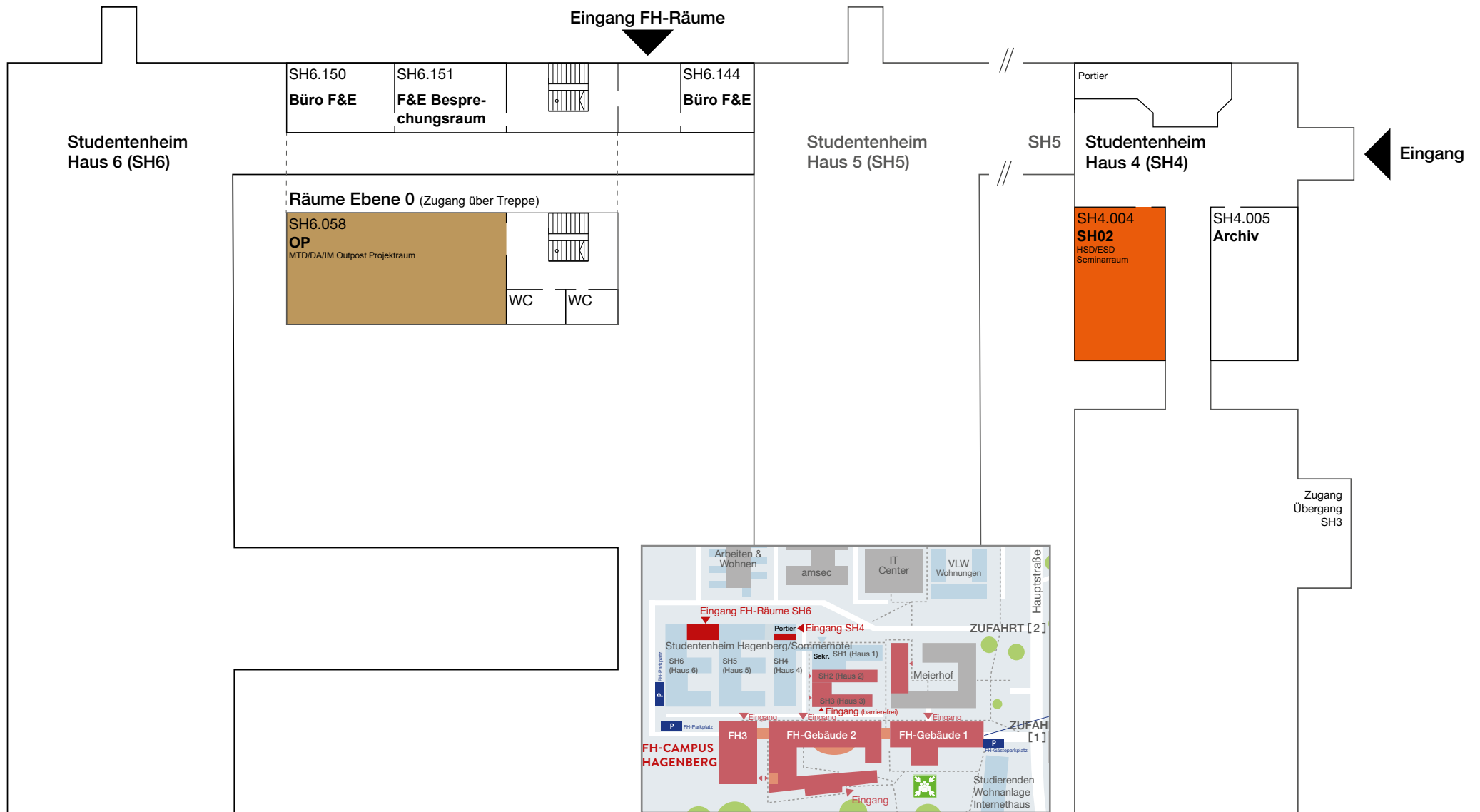

Studentenheim Haus 6 Ebene 1/0 (Softwarepark 23, Zugang FH-Räume Nordseite gegenüber „Arbeiten & Wohnen“)

Studentenheim Haus 4 (Softwarepark 23 Zugang FH-Räume Haupteingang/Portier)

